

Suitable to be used with medium & large workpiece (Can do 5 sides machining)

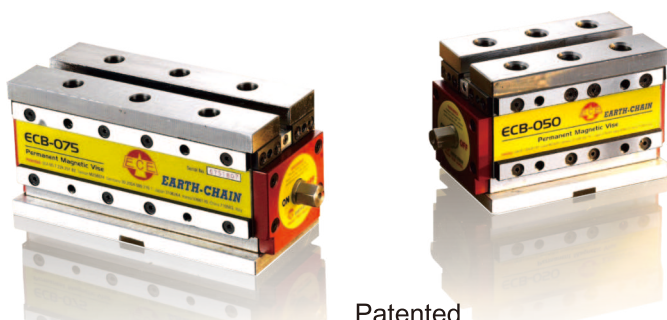

Patented

Taiwan M258824, Italy 1414610, USA us7, 224, 251, B2, Japan 3106264, Korea 0366170, Germany 20 2004 009 776.1, China ZL2004 2 0067865.1

### Features:

1. The all new model Magnetic Clamping Block ECB Series are a new sense of clamping way for metal working on CNC Machining Center and Milling Machine in quick clamp workpieces.
2. Free to set up position, numbers and distance of Magnetic Clamping Block according to the size of workpiece.
3. The ECB Series including changeable Induction Soft Block. It can be revised the surface to be 100% accuracy on the machine for clamp workpieces. Can be also cutting, drilling, tapping and slotting directly to the Induction Soft Block during machining workpiece. Multi-function of Induction Soft Block, the user can make it by themselves according to workpiece required.
4. Two machining circle for finish workpiece machining, increase a lot of machining efficiency and achieve accuracy required.

### Applications:

1. Most suitable for medium and large size of workpiece machining on milling machine and CNC machining center.
2. Minimum size of workpiece required as bigger than an area of two Magnetic Clamping Blocks.
3. The Magnetic Clamping Blocks are not suitable for small workpiece clamping.



### Note:

1. Please always make sure the Switch was in ON position before machining.
2. The Magnetic Clamping Blocks are not suitable for non-magnetic material, such as brass, copper, aluminum and stainless steel, etc.
3. The principle of Magnetic Clamping Blocks is magnetism of N. S. poles, so please always put the workpiece between N. S. poles.  
(The middle of top clamping range)

### Working Example

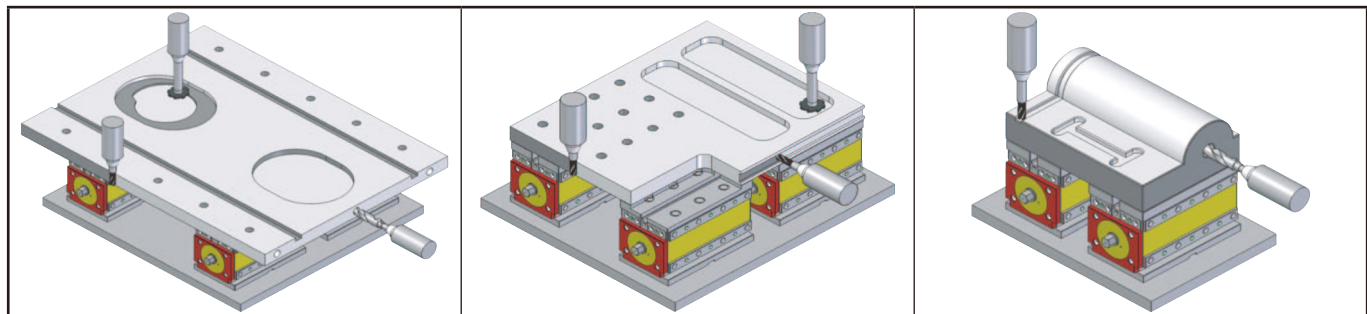

MODEL NO	HOLDING POWER	MINIMUM THICKNESS OF WORKPIECE REQUIRED	G	H	Height Total (including Induction Block)	N.W.
ECB-210	2100kgf±5%	30	115	134	155	36kg
ECB-120	1200kgf±5%	20	92.5	108	123	18kg
ECB-075	750kgf±5%	15	85	78	90	9.5kg
ECB-050	500kgf±5%	15	61	78	90	7kg

Continual to next page.

Suitable to be used with medium & large workpiece (Can do 5 sides machining)

## Dimension ECB-210

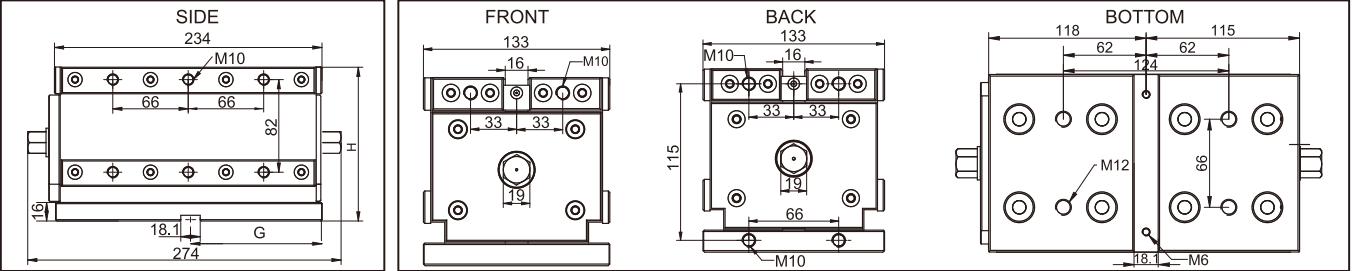

## ECB-120

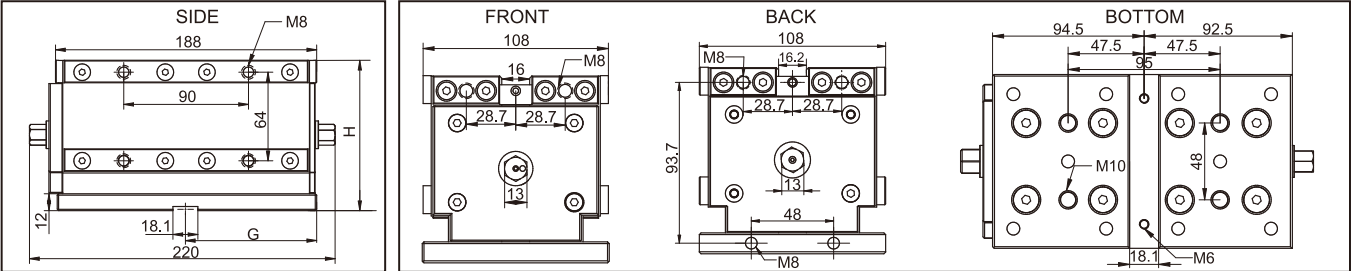

## ECB-075

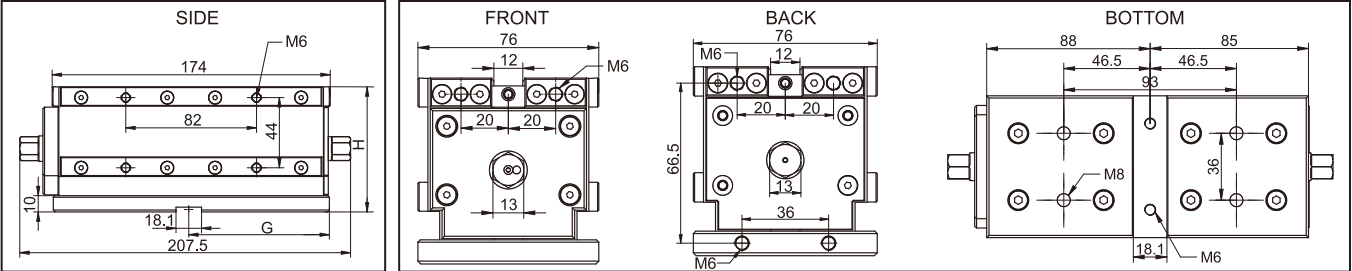

## ECB-050

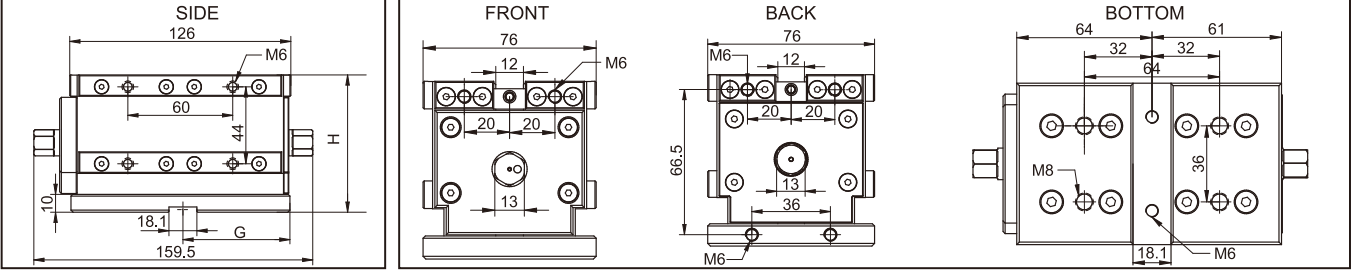

# Permanent Magnetic Clamping

**ECB Series**

Suitable to be used with medium & large workpiece (Can do 5 sides machining)

Customer can be makes switch connector by standard hexagon steel bar themselves for depends on length required. The dimension of hexagon bar required as ECB-210 --- 19mm, ECB-120, 075, 050 --- 13mm.

Maximum & Minimum distance required

MODEL NO		ECB-210	ECB-120	ECB-075	ECB-050
SIDE DISTANCE	Min.	100	60	25	25
	Max.	1000	600	400	400
FRONT & BACK DISTANCE	Min.	70	40	40	40
	Max.	500	300	200	200

Unit:mm

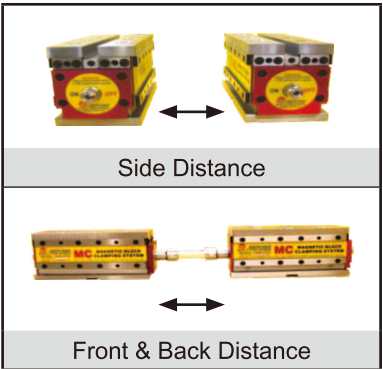

## Special made Induction Block:

Customer can makes special induction block themselves for depends on the workpiece and application required.  
(The material of induction block required as general and low carbon steel)

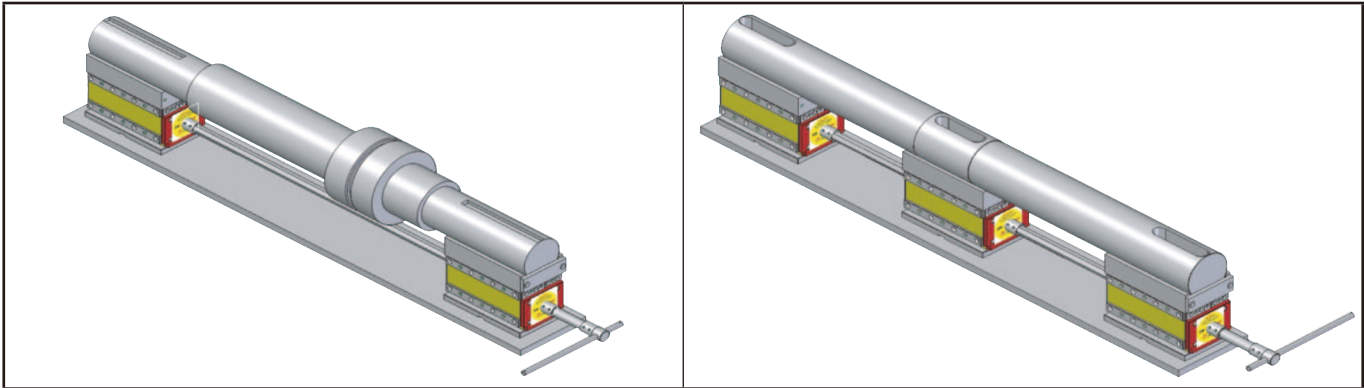
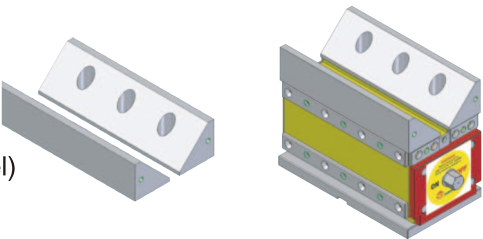

## Working Example

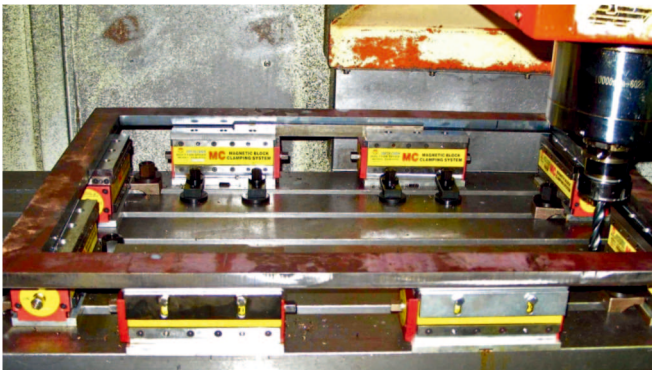
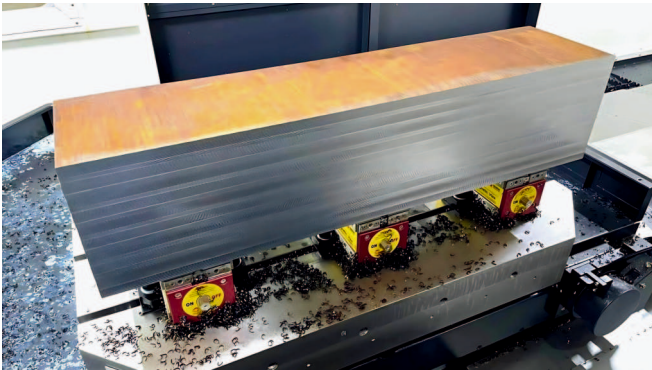



Automatic Switching System For ECB Series Permanent Magnetic Clamping Block.

Used for enable the automatic production line with ECB Series.

The Gear Motor with reducer can automatically switching the magnetization and demagnetization operation, which saves time and labor, suitable for large size machines which using our ECB Series products.

Panted Patent No:Taiwan M644135

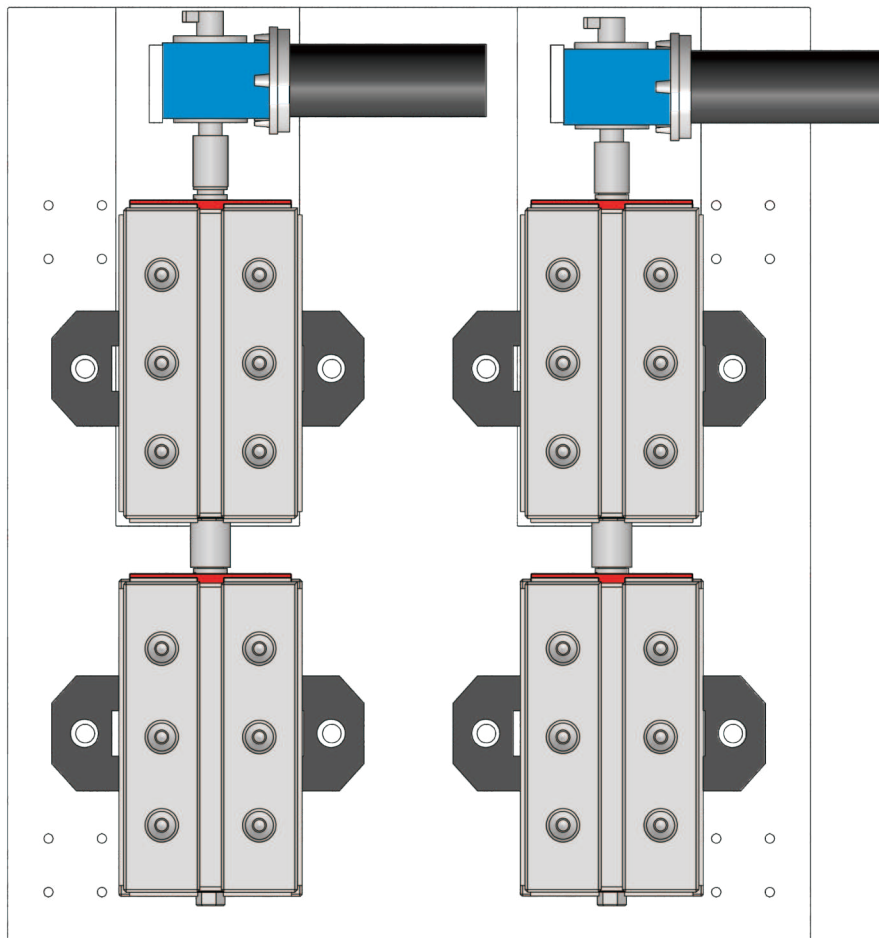

### Working Example





# Permanent Magnetic Clamping

ECB Series

Suitable to be used with medium & large workpiece (Can do 5 sides machining)

## Working Example

